

Leaf+Bean

One Hand Smart Coffee Grinder

G0000041

Instruction Manual

Thank you for choosing the Leaf & Bean One Hand Smart Coffee Grinder. To ensure proper operation and to maintain the lifespan of your device, please read these instructions carefully before use.

Product Overview

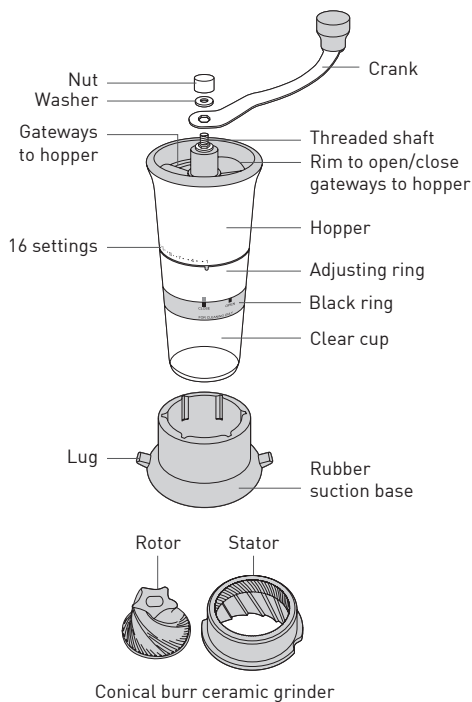

Important Safety Precautions

- For roasted coffee beans and household use only.

Assembly Instructions

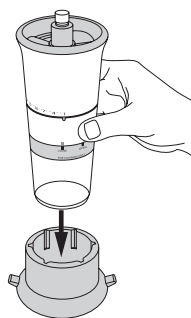

1. Place the rubber suction base on countertop. Insert the grinder in rubber suction base.

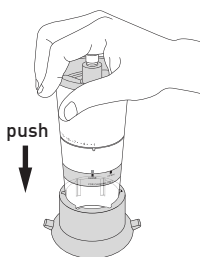

2. Hold the grinder over the top of rubber base and push downwards until grinder cannot go any further. The rubber suction base will not attach to countertops with rough and grainy textured surfaces.

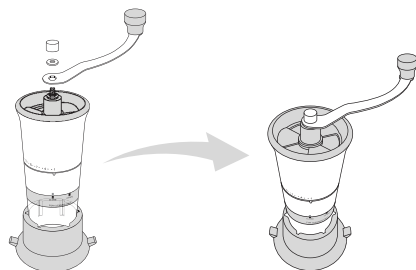

3. Unscrew the nut and take out the white washer from threaded shaft. Attach the crank to the threaded shaft, making sure that the hexagonal shape on the crank fits into the hexagonal hole at the end of the threaded shaft. Replace the white washer and then attach the nut. Screw the nut until tight.

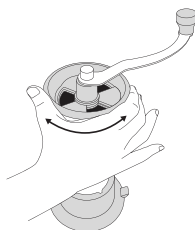

4. The grinder is ready for pouring in coffee beans. Simply twist the black hopper rim in either direction for the hopper gateways to open.

Operating Instructions

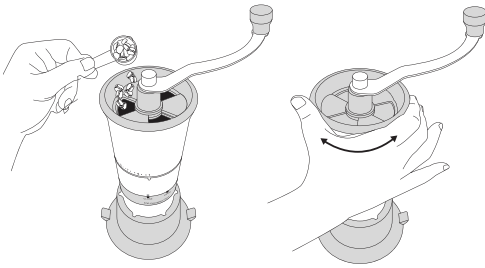

1. Pour beans into hopper through top holes. Twist again in either direction to shut hopper gateways.

Tip: Max fill is approx. 50g (1.8oz). Always run the grinder out of beans in each operation. Any beans left in hopper, broken beans retained in ceramic grinder and grounds held in clear cup are in contact with air and will start losing their original flavour and freshness, so it is best to use them immediately.

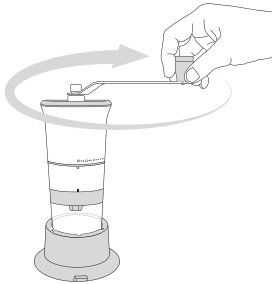

2. Once the rubber suction base is attached firmly to the countertop and beans are within the hopper, grab the knob of crank and turn clockwise.

Grind Size Selection

Hold the hopper with one hand and twist the adjusting ring with your other hand to select grind setting from 1 to 16.

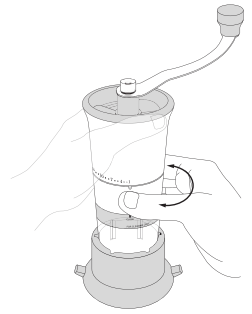

Coarse grind: Percolator and French press,

Medium grind: Pour over, automatic drip

Fine grind: Espresso and moka.

Setting 1 turns out the finest grind and the coarsest grind is setting 16.

Tip: To determine the right grind, experiment with different settings and coffee types to suit your taste. While changing the setting from coarse to fine, turn the crank a bit to help twist the adjusting ring.

Removing Coffee Grounds

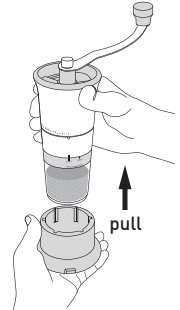

1. To access ground coffee, first remove rubber base from countertop by pulling on one of the lugs.

2. Hold and squeeze the rubber base to help pull out the grinder from base.

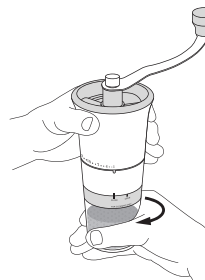

3. To remove clear cup, hold the hopper with one hand and twist the clear cup to "OPEN" with the other hand.

Care Instructions

Wipe the silicone rubber base with a damp cloth. Coffee oil and some aromatic compounds in the coffee bean will start building up on ceramic grinder after use, so periodical cleaning is required to ensure the freshness of ground coffee.

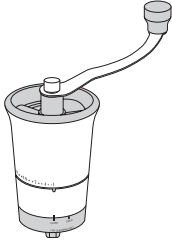

1. To access ceramic grinder for cleaning, empty the hopper, turn the crank to grind out beans held in ceramic grinder then remove the clear cup.

setting 1

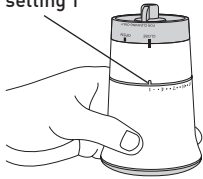

2. Twist the adjusting ring to setting 1 for the finest grind and then turn the whole grinder upside down with "CLOSE" and "OPEN" visible.

3. Twist the black ring to "OPEN" and lift to remove it.

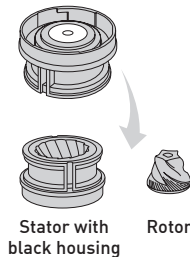
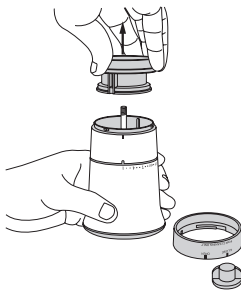

4. Unscrew the nut anti-clockwise from the end of the shaft and then pull the ceramic grinding unit out of the hopper. The ceramic grinding unit includes a rotor and a stator. Rinse parts under running water. Dry thoroughly before replacing parts and storing. Tip: a kitchen brush is handy for cleaning under tap.

Replacing Parts After Cleaning

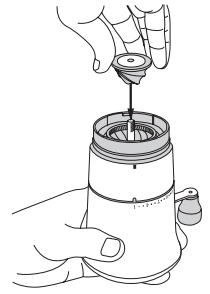
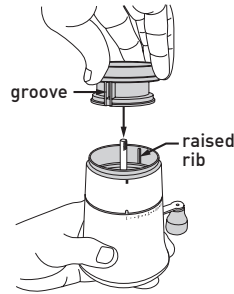

1. Check the setting remains at 1. Invert the hopper then slide the stator with housing into hopper by guiding either grooves in housing to either raised ribs in hopper.

2. Put the rotor with white support back onto the shaft. If rotor and white support are separate, put rotor back first then the white support.

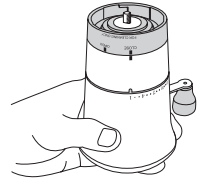
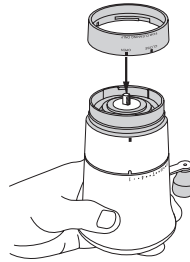

3. Align "OPEN" on black ring with the index on adjusting ring to replace the black ring then twist until "CLOSE" points to the index.

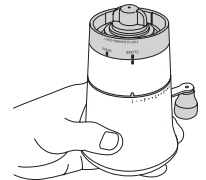
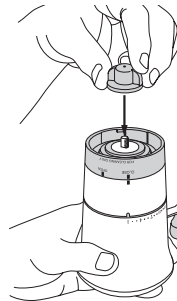

4. Place the nut back onto the shaft and turn it clockwise until screwed tight. Tip: Hold the crank still and screw the nut a little closer to rotor with white support. This will help the finest grind setting grind even finer.

IsAlbi

87 Chifley Drive, Preston, Victoria 3072

P: +61 (03) 9474 1300

E: enquiries@isalbi.com.au

isalbi.com.au