



## 2 in 1 Precision **Electronic Scale**

G0000046

Thank you for choosing the SVNA 2 in 1 Precision Electronic Scale. To ensure proper operation and to maintain the lifespan of your device, please read these instructions carefully before use.

### PRODUCT OVERVIEW

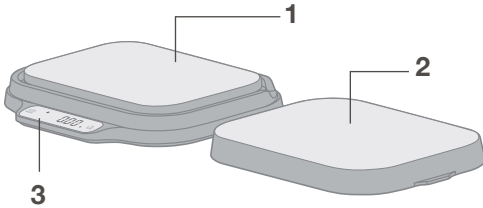

1. Fine scale Platform
2. Main scale platform/lid
3. Control Panel

### CONTROL PANEL OVERVIEW

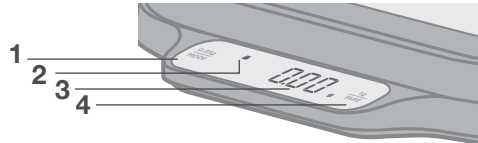

- 1. Mode Button**
  - Long press for 2 seconds to turn on the fine scale.
  - Short press to switch between units (g/kg/oz/lb).
- 2. Scale weight indicator**
  - This will flash green when the scale is in fine scale mode and white when in main scale mode.
  - Long press Mode button to change between scale modes.
- 3. Weight display**
- 4. Tare button**
  - Press tare button to turn on the scales.
  - Long press tare button for 5 seconds to manually turn off the scales.
  - The scale will automatically turn off after 120 seconds without use.
  - Short press to reset the display weight to zero.

### PACKAGING AND RECYCLING

The materials used for this product's packaging can be reused, recycled and disposed of through specific waste streams.

- **REUSE:** Keep packaging to safely store or transport your appliance, preventing damage.
- **RECYCLE:** Look for recycling symbols on packaging components to identify if they are recyclable. Check with your local authority to find out what materials are accepted for recycling in your area.
- **DISPOSE:** Look for symbols on packaging components and dispose of materials accordingly.

### TECHNICAL INFORMATION

- Equipped with high precision strain gauge sensor system.
- Large stainless steel weighing platform.
- Capacity: Main scale 5g–15kg, Fine scale 1g–1kg.
- Divisions: Main scale 1g, Fine scale 0.05g.
- High-definition white LED Display.
- TARE and HOLD functions.
- Touch panel switch / Auto off function.
- Auto zero resetting.
- Low power / Over-load indicators.
- Units (g/kg/oz.lb).
- Power: 3 x 1.5V AAA battery.

### INSERTING THE BATTERIES

1. Open the battery cover.
2. Install 3 x 1.5V AA batteries as shown.
3. After installing the batteries, replace the battery cover.

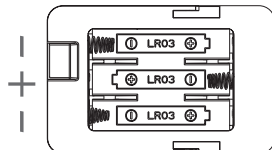

# OPERATING INSTRUCTIONS

## WEIGHING WITH THE MAIN SCALE (MAX 15KG)

The main scale must be used together with the lid.

- Place the scale on a hard and flat surface.
- Press TARE to turn on the scale.
- Put the food on the platform and the weight will be displayed.
- During main scale weighing, if the weight exceeds 1000g, the unit will display the weight in kilograms instead of grams.

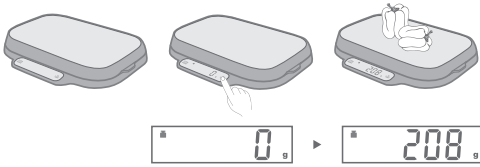

## WEIGHING WITH THE FINE SCALE (MAX 1KG)

The lid must be removed before using the fine scale.

- Place the scale on a hard and flat surface.
- Long press MODE key for 2 seconds to turn on the fine scale. Multiple figures of 8 will appear on the LED display.
- The weight symbol will turn green, indicating the scale is in fine scale weighing mode. If the lid is left on while an item is weighed on the fine scale, the display screen will not show the item's weight, as it remains in main scale weighing mode. Removing the lid will enable the fine scale weighing mode.
- Put the food on the platform and the weight will be displayed.

Tip: The main scale lid can double as a multi-functional food weigher in fine scale mode. Simply turn the lid upside down and place your food in the groove on the underside of the lid to weigh it.



## TARE FUNCTION

- Place your object on the fine scale weighing platform. The LED display will show the weight of the object.
- Press TARE to clear the weight of the container (display weight will reset to zero), then put the food into the container. The LED display will show the weight of food only. Repeatedly press TARE to weigh different foods.
- The LED display will show the negative value of container if you remove the food and container from the platform together. Long press TARE for 2 seconds to reset the display to zero.



## HOLD FUNCTION

Long press the MODE and TARE buttons together for 2 seconds to turn on the HOLD function. The LED display will show 'H-ON' to signify the hold function is on.

Place food onto the platform. The LED display will show the weight of the food. The scale will beep once and the weight will be locked. The weight will remain displayed when you remove the food from the platform.

To turn off HOLD function, long press MODE and TARE buttons together for 2 seconds again. H-OFF will show on the LED display to signify the hold function is off.



## CARE INSTRUCTIONS

Place scale on a hard and flat surface to ensure the greatest accuracy.

Do not drop or subject the scale to shocks as this may damage the unit.

Do not use abrasive cleaners.

Clean the scale with a damp cloth, but do not allow water to enter the scale.

To protect the life of the scale, keep out of hot or wet environments.

Remove battery from scale if it has not been used for a long period.

If scale does not operate, check battery is correctly positioned. Battery may become flat when scale is not used for prolonged periods of time and may need replacement.

Do not store the scale in an upright position, always store flat.

Do not stack other items on top of scale when storing.

## ERROR INDICATION



Low power.



Scale is overloaded (over 15kg for main scale, over 1kg for fine scale).



Scale is unstable. Place on a hard and flat surface and restart.



Scale has been overloaded before switching on, remove the excess weight and restart. Else a sensor has been damaged due to improper use. Main scale is on without lid. Put the lid on before using main scale.

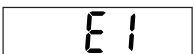

Continuous use of main scale without lid may damage fine scale sensor.

## **CONTACT**

IsAlbi  
87 Chifley Drive, Preston, Victoria 3072  
P: +61 (03) 9474 1300  
E: [enquiries@isalbi.com.au](mailto:enquiries@isalbi.com.au)