

# ILLUMINATE *Jellyfish* LAMP

Watch as the  
jellyfish dance and  
swim in water.

Simply plug the USB-DC cable (included) into a power source or insert 3x AAA batteries (not included) and follow the instructions to create a maintenance-free jellyfish aquarium.

## CONTENTS:

1.



2.

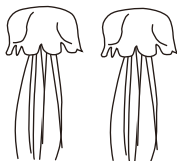

3.



## INCLUDES:

1. 22cm Light with removable lid for the jellyfish aquarium
2. 2x Jellyfish
3. 2m USB-DC Cable

Size: 8.3 x 8.3 x 22cm  
Input: 5V 1A MAX  
Output: 5V 200mA

## INSTRUCTIONS:

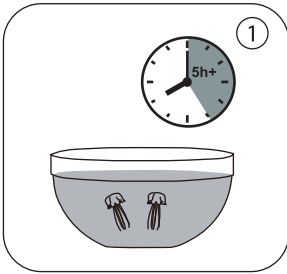

1. Unpack the two jellyfish and soak them in clean water for a minimum of 5 hours

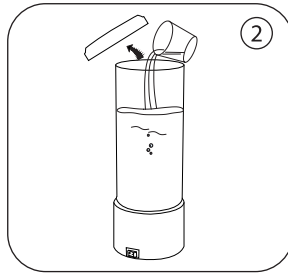

2. After 5 hours, fill the container of the jellyfish lamp with clean water. Ensure that the container is not overfilled.

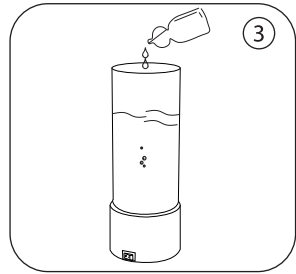

3. Add 2-3 drops of liquid dishwashing detergent to the water.

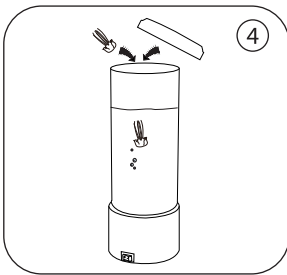

4. To remove air from the pump turn the ON/OFF switch a few times. Place the soaked jellyfish into the container. To avoid air bubbles forming under your jellyfish heads, slowly insert the jellyfish upside down with the top of their heads facing towards the bottom of the container until the jellyfish are completely submerged.

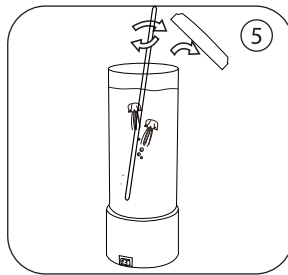

5. You can use a wooden skewer (not included) to remove the bubbles.

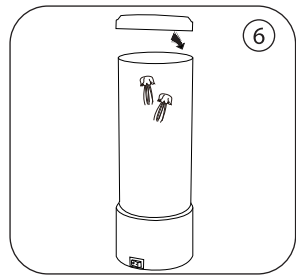

6. Place the lid on the top of the jellyfish lamp.

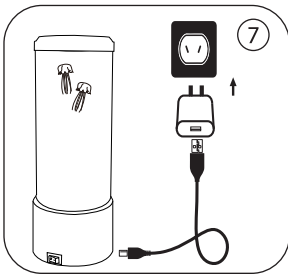

7. If using USB cable: insert the DC plug into the back of the Jellyfish Lamp base and plug the USB cable into a power source.

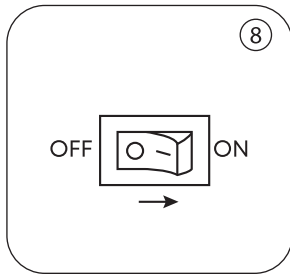

8. Flip the switch to the ON position and watch your jellyfish swim under the changing colour of the LED light.

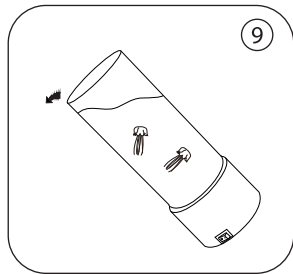

9. When you notice the water of your Jellyfish Lamp become cloudy, carefully pour out the water and repeat from Step 2.

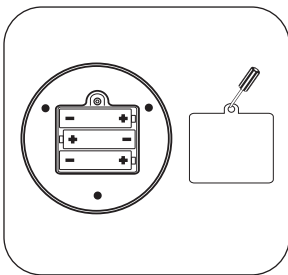

The light can be operated by 3x AAA batteries (not included) or by USB cable (preferred).

If using batteries to operate the Jellyfish lamp, please unscrew and remove the battery lid, insert the batteries observing the proper polarity and secure the lid in place with the screw.

#### Battery information

3 x AAA replaceable batteries (not incl.)

Remove the screw and cover, insert batteries with the correct polarity (+ and -), replace the cover and screw securely

Non-rechargeable batteries are not to be recharged

Rechargeable batteries are only to be charged under adult supervision

Rechargeable batteries are to be removed from the product before being charged

Different types of batteries or new and used batteries are not to be mixed

Exhausted batteries are to be removed from the product.

The supply terminals are not to be short-circuited

Packaging has to be kept as it contains important information.

If storing for long periods of time, we recommend you remove the batteries

NOTE: When replacing batteries, please separate old batteries from normal waste and dispose of correctly at an accredited battery recycling location. Batteries should not be disposed in household bins. Please handle batteries with caution.

Remove the batteries if the light is not to be used for an extended period of time. Pour out the water, clean and dry the container and all accessories, then store them in the original packaging. Do not keep the lamp working more than 8 hours each day to save the life of motor.

#### FOR INDOOR AND DOMESTIC USE ONLY. THIS IS NOT A TOY.

This product is intended for display purposes and not for children to use in play. Keep out of reach of young children.

**HANDLE WITH CARE.** Display in a cool dry place, do not leave in direct sunlight or near heating or cooling vents. If breakage occurs, clean the area and discard of product.

Please turn off the light before cleaning. Always use soft cloth and clean water to clean the container. Do not submerge the whole lamp into water for cleaning. The LED bulb is not replaceable. Do not attempt to open the lamp. Properly dispose of the product if damaged and battery leakage occurs.

**IDZ82034 JELLYFISH LAMP**

**MADE IN CHINA**



Packaging designed  
in Australia.  
© IS GIFT 2025.  
All rights reserved.

Distributed by IsAlbi  
PO Box 7120 Warringah Mall  
NSW 2100 Australia  
[www.isalbi.com.au](http://www.isalbi.com.au)

